

BASEMENT WALL FORMS

EXTRUTECH PLASTICS, INC.

MADE IN THE USA

Since 1992



House using Extrutech Basement FORM System.

Extrutech FORM panel comes 24" wide, 6" or 8" thick, and 6' to 20' long. The panels snap and lock together to form your basement walls. These forms are drilled with holes to allow the cement to flow from one section to another and also hold reinforcing steel rebar.

Electrical raceways can also be added inside the FORM. Fill with 4,000# PSI cement. Add your first floor framing and complete the house. Basement sizes can be custom designed by you. We supply the custom made forms as a kit that you put together to form the basement walls.



Basement walls using 8" thick Extrutech FORM system.

FIVE EASY STEPS

1. Assemble FORMS on footings
2. Load Rebar for reinforcement
3. Brace Forms
4. Fill with cement, let cure
5. Walls done

EXTRUTECH FORM
6" and 8" Thick Walls
24" Wide Panels
Snap and Lock Together
Easy Assemble
Custom Lengths
Stay-In-Place
Water-Proof



8" Insulated FORM Panel

888-818-0118

www.epiplastics.com

email: info@epiplastics.com

EXTRUTECH PLASTICS, INC.

5902 W. Custer Street, Manitowoc, WI 54220

Fax: 920-684-4344



EXTRUTECH PLASTICS, INC.

Water-Proof Concrete Wall FORM® System

MADE IN THE USA

Advantages:

- Quick Installation, no finishing required
- Perfect for high moisture areas, where corrosion can be a problem
- Two foot wide panels means fewer seams
- Custom cut panel to 20' long
- Snaps together for quick installation
- Double spline, E-locking system
- Use standard rebar reinforcing methods
- Waterproof and corrosion-proof
- Rodent, termite, and insect-proof
- Panels will not rust, rot, or flake
- Resists mold, mildew, and bacterial growth
- Low V.O.C. panels with honeycomb interior walls for maximum panel stability
- Protective film that is easy to peel off and keeps panels clean during construction
- Stay-in-place, no forms to strip

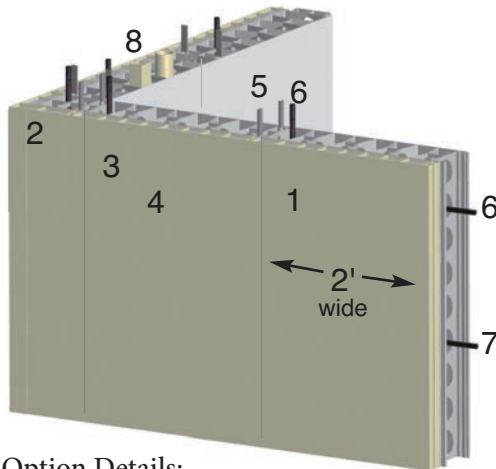

Feature and Option Details:

1. 2' Wide Panel (Quicker setup, stronger panel, less handling)
2. 2" Insulated Panel (Insulated barrier inside a pre-finished exterior surface)
3. Colored Panels (Available in White, Beige, and Gray exterior colors)
4. Clear Protective Film (Keeps panels clean during construction)
5. Double Spline E-Locking System (Insert two splines at each joint to lock the panels together, for secure, leakproof joints)
6. Horizontal and Vertical rebar (per project specifications)
7. Male/Female Edge Connection (Quick snap-together connection)
8. Electrical Chase (Providing electrical access as needed)
9. Custom size basement made to your print
10. Easy to Assemble
11. ICC ES Certified
12. ISO 9001-2015 Certified
13. Class A available



Concrete FORMS with rebar.



Fill FORMS with 4000# PSI cement.



Finished house basement walls ready for floor framing.

888-818-0118

www.epiplastics.com

email: info@epiplastics.com

EXTRUTECH PLASTICS, INC.

5902 W. Custer Street, Manitowoc, WI 54220

Fax: 920-684-4344

